

# Mpur



## Adaptability

M-pur gives full consideration to space and target user.

- It creates traditional or modern diversified styles to meet the requirements of mobile office and static office in the new century.
- Privacy and openness is optional and switchable.
- Lightweight multimedia: high efficiency, small input, wide applications, user-friendly multimedia applications
- The considerate function design, storage, wiring and various accessories enable personalization and convenience.

## Multi-function

Workstations for employees, managers, directors, trainings and conferences.

## Color variety

Rich expression from four dimensions

Spring, summer, autumn and winter

## Wide price range

Wide budget range available, perfect for different stages of corporate development



## Stable, modular and user-friendly

- The comprehensive modular structure enables a more stable combination, multi-angle connection and convenient recombination.
- Flexible and powerful wiring function: Realizing comprehensive and well-organized wiring management.
- The standard cloth screen adopts a combination of wood and metal, creating a more stable structure and optimized noise insulation effect than the metal structure.
- The auxiliary functions double the working efficiency: The introduction of creative tray and pen container makes the work plan more visible.



## Major forms



U: with U-shaped slot



U: with U-shaped slot



L: with retracting wiring base



U/L: with U-shaped slot and retracting wiring base

## Major forms



Meeting table



Meeting table expansion

# Use of table extension

## Extension

Horizontally connected with the shared independent square table



① Square table



② Extension

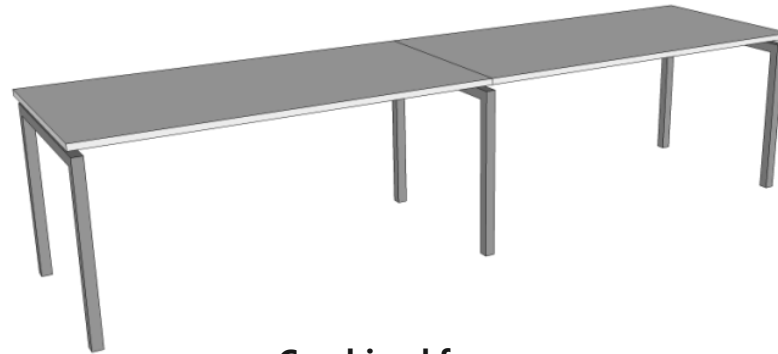

Combined form

# Lift table adjustment instructions

Height adjustment range: 710-1120mm

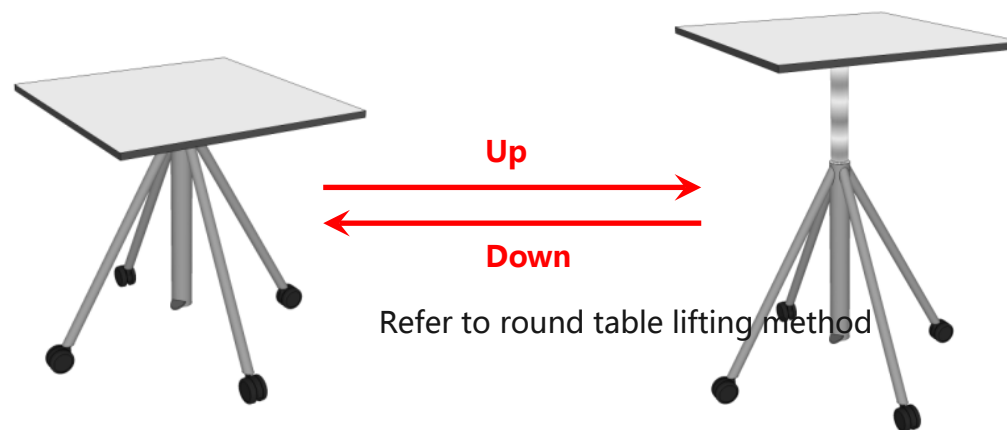
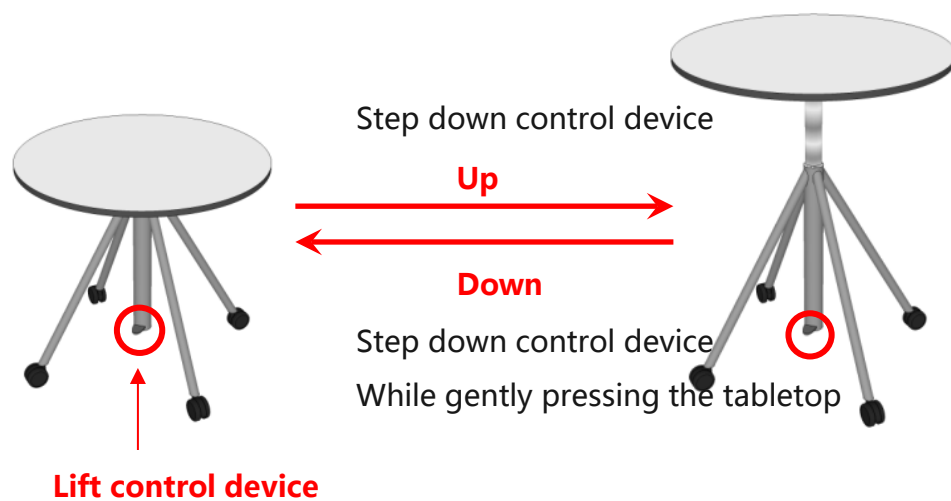

# Screen model

## Hanging rack

- Hanging slot size: D25mm H75mm; if adopt the 25mm table top, the hanging rack height is H175mm
- Aluminum hanging slot, color options: dusting or anodized aluminum; grey plastic edge cover
- Aluminum hanging slot can support screen pendant
- Aluminum hanging slot dusting color range: sand white C-S-A-31, silver grey C-S-A-18



## Rack screen

- Two types:
  - ① D25mm H375mm; 5 aluminum hanging slots
  - ② D25mm H450mm; 6 aluminum hanging slots
- Aluminum hanging slot and edge cover, color options: dusting or anodized aluminum
- Aluminum hanging slot can support screen pendant
- Aluminum hanging slot spray powder color range: sand white C-S-A-31, silver grey C-S-A-18

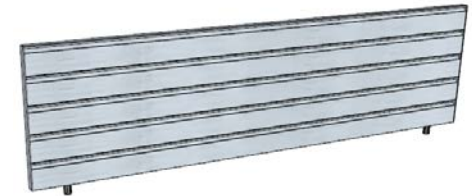

## Cloth screen

- Two types:
  - ① D25mm H375mm
  - ② D25mm H450mm
- Cloth face at middle of screen; one upper aluminum slot and one lower, aluminum edge cover, color options: dusting or anodized aluminum
- Aluminum hanging slot can support screen pendant
- Aluminum hanging slot and edge cover spray powder color range: sand white C-S-A-31, silver grey C-S-A-18
- Cloth color range: refer to standard color card

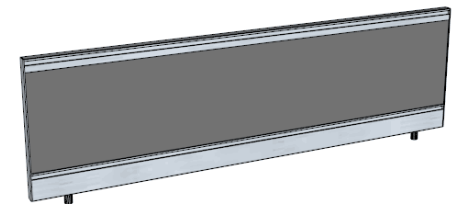



# Screen model

## Glass screen on rack

- Size: H200mm Chamfer R50mm
- 6mm toughened frosting glass
- Dusting aluminum glass block, dusting color range: sand white C-S-A-31, silver grey C-S-A-18

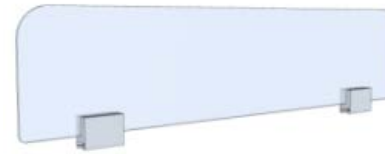

## U-shaped slot screen

- Slot screen, D20mm, H300/360mm, used for U-shaped slot
- Chipboard substrate, cloth surface
- Cloth color range: refer to standard color card

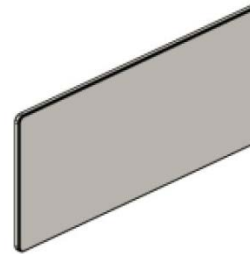

## Cloth hanging screen

- Size: D20mm, H750mm
- Chipboard substrate, cloth surface
- Cloth color range: refer to standard color card

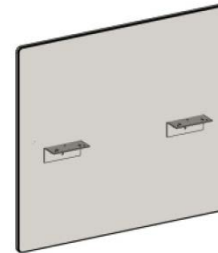

# Wiring management

## Horizontal alignment

Through cableway

## Vertical alignment

Through wiring post (6) & serpentine tube (16-20) & shared base  
Inside cabinet

Floor cabinet has top opening, so  
that electrical products can connect  
with socket panel through desktop  
U-shaped hole

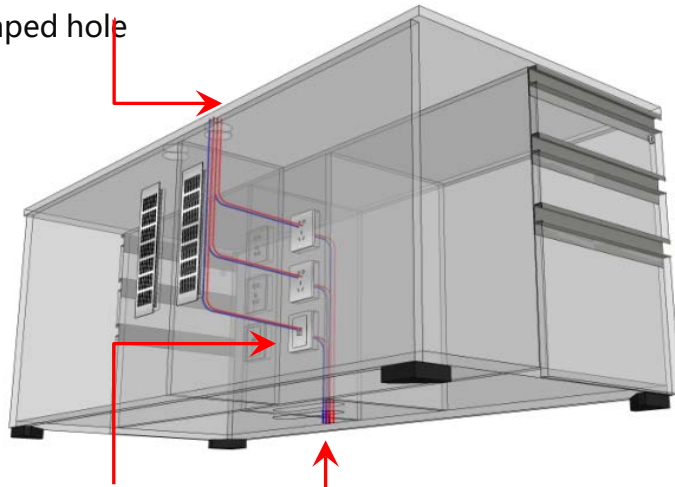

Standard 86 panel  
holes inside cabinet  
A standard 86-socket  
panel can be installed

Bottom wiring  
point



L: with retracting wiring base



# Wiring management

## 1. Side cabinet wiring sketch map

1. Side cabinet has top opening, so that electrical products can connect with socket panel through desktop circular hole

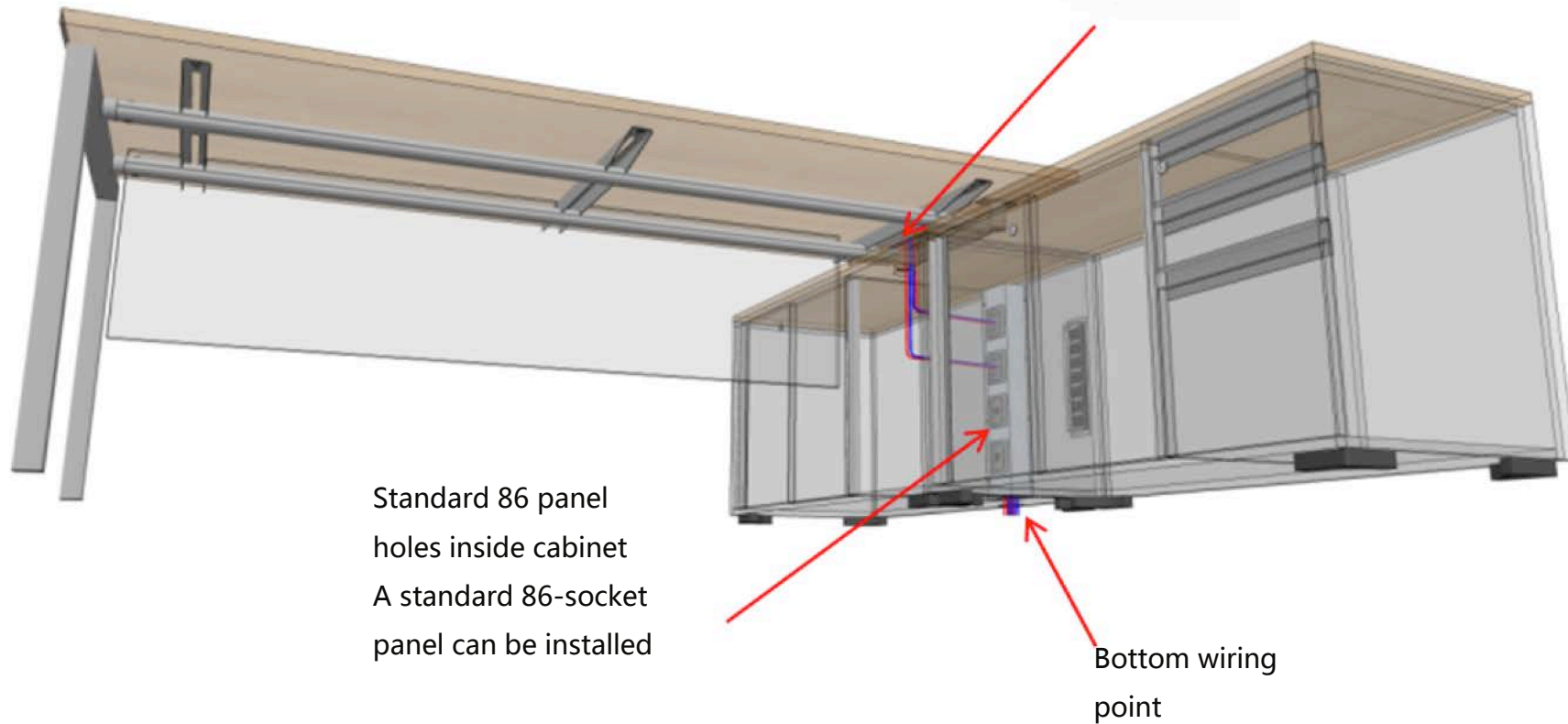

# Accessories

Multiple accessories are available for screen hanging slot to offer rich functionality

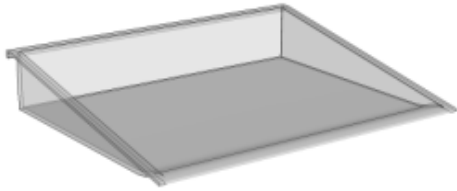

Mail tray



Pen holder



Screen partition



Nameplate



Monitor arm



Computer frame



External whiteboard

## Side cabinet model

- Multiple side cabinet models available
- Three heights available: 647/1200/1350
- With or without host computer
- Wardrobe option
- Diversified choices for customer

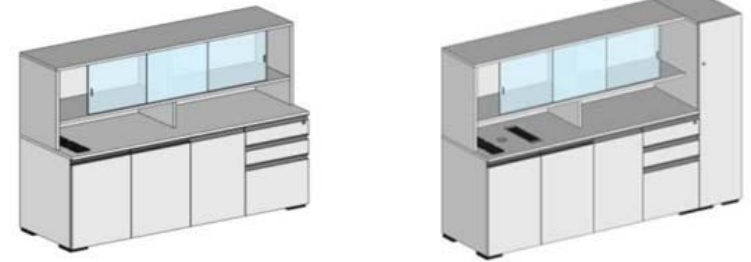
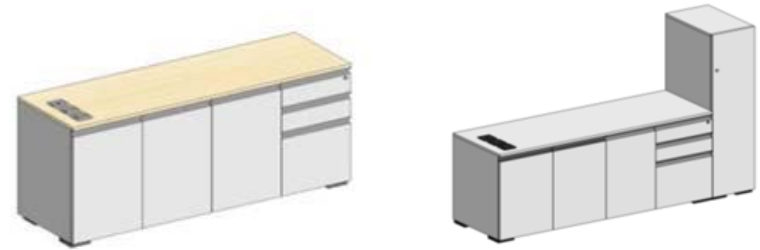

## Floor cabinet model

Executive desk seats are designed either on the left or right. R indicates that floor cabinet is connected to the right side of desktop after having seat. L indicates that floor cabinet is connected to the left side of desktop after having seat.









SHANGHAI  
BEIJING  
SHENZHEN  
WUHAN

© 2020 Matsu Group

www.matsu.cn



# Inspiring Office Lifestyle

创造激发灵感的办公生活方式

## 玛祖铭立集团

成立于 1996 年，一直致力于为高端客户提供个性化、极致设计的办公空间整体解决方案，旗下产品涵盖办公空间家具、公共空间家具、LED 照明系统、办公室隔断系统、地毯，以期为客户创造激发灵感的办公生活方式。

玛祖铭立自 2001 年与德国著名家具企业 Kusch+co 建立合作至今，已与八个德国高端品牌结成密切的战略合作伙伴，并在中国建立生产基地，精良严谨的德国工艺与作业风格贯穿整个制造体系与工作环节。

## MATSU GROUP

上海市徐汇区肇嘉浜路 686 号

No. 686 Zhaoliabang Road, Xuhui District, Shanghai, P. R. China, P.C.: 200030

T +86 21 3338 6166

Customer Service Hotline 400 630 9229

**MATSU** 玛祖铭立  
GROUP

